

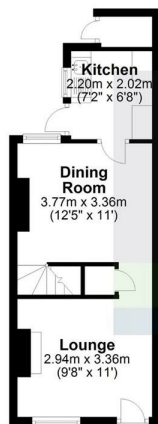

Keith  
Ashton

North Road Avenue,  
Brentwood

### Ground Floor



### First Floor



APPROX INTERNAL FLOOR AREA  
5790 N 6650 FT

This plan is for layout guidance only and is NOT TO SCALE. Whilst every care is taken in the preparation of this plan, please check all dimensions, shapes & compass bearings before making any decisions reliant upon them.  
Copyright Keith Ashton



## 88 North Road Avenue, Brentwood, CM14 4XN

Situated in an ideal location very close to the High Street and within walking distance of Brentwood Mainline Railway Station, is this attractive Victorian cottage. Presented to a very high standard throughout, the living room has plenty of character including a feature fireplace and is tastefully decorated. It leads through to a separate dining area with window to the rear which gives access to the modern kitchen, with a window and door to the rear.

Stairs from the lounge lead to the first floor, where there are two well-proportioned bedrooms with feature fireplaces, along with the bathroom which is fitted with a modern white suite. There is also a spacious loft.

Externally, the property enjoys a fairly private garden, which is mainly laid to lawn with mature borders. To the front parking is on a permit basis.



## Offers In Excess Of £350,000

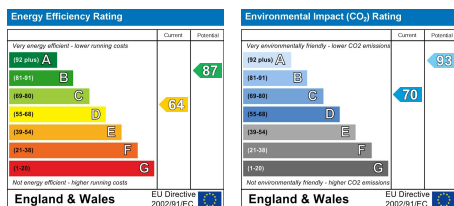

### SERVICES:

Local Authority: Brentwood  
Council tax band: C  
Post code: CM14 4XN

### VIEWING:

Strictly by prior arrangement with Keith Ashton Estate Agents

### OPENING HOURS:

Monday to Friday: 8.45AM - 6.30PM | Saturdays: 9AM - 5.30PM | Sundays: 10AM - 2PM

**MORTGAGE INFORMATION:** We offer the additional facility of an in-house Independent Financial Adviser who will access all mortgage lenders with the purpose of providing you with the benefit of choice. For quotations or comparables please call 01277 260858 or visit our interactive website at [www.mortgagebusiness.net](http://www.mortgagebusiness.net)



We the Agent have not tested any apparatus, fittings or services for this property. The plot size is intended merely as a guide and has not been officially measured or verified by the Agent. Photographs are for illustration only and may depict items which are not for sale or included in the sale of the property. As part of the service we offer we may recommend ancillary services to you which we believe may help you with your property transaction. We wish to make you aware, that should you decide to use these services we will receive a referral fee. For full and detailed information please visit 'terms and conditions' on our website [www.keithashton.co.uk](http://www.keithashton.co.uk)

Brentwood  
Tel. 01277 260858

Village Office  
Tel. 01277 375757

Lettings Office  
Tel. 01277 202200

Explore more @ [www.keithashton.co.uk](http://www.keithashton.co.uk)

